



## 41 Hillside Road Newport NSW

3  1  1 

Positioned above the Crown of Newport Reserve and a short walk from Newport Beach and shops, this home provides the very best of living on the Peninsula. This dual level property is set amongst the tree canopy with spectacular area views and retaining much of its original charm with open plan interiors flowing naturally onto huge sun-drenched decks on both levels, creating a stunning and versatile layout.

- Bathed in natural light & fresh sea breeze
- Flexible floor plan, with multiple living areas
- Good size bedrooms, full sized bathroom, gas fireplace
- Huge, wide entertaining decks on both levels + rear garden
- Surrounded by gorgeous gums and lush tropical trees

[For full version visit the website](https://www.cjhills.com.au)

**Type** : House  
**Land Size** : 669 sqm  
**View** : <https://www.cjhills.com.au/lease/nsw/northern-beaches/newport/residential/house/8026698>



**Colin Hills**  
 02 9918 3864

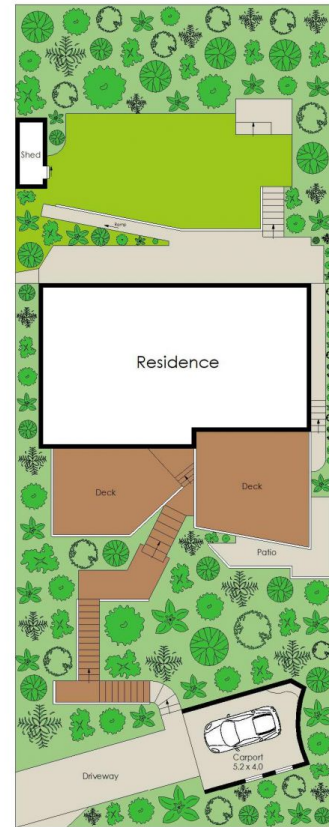
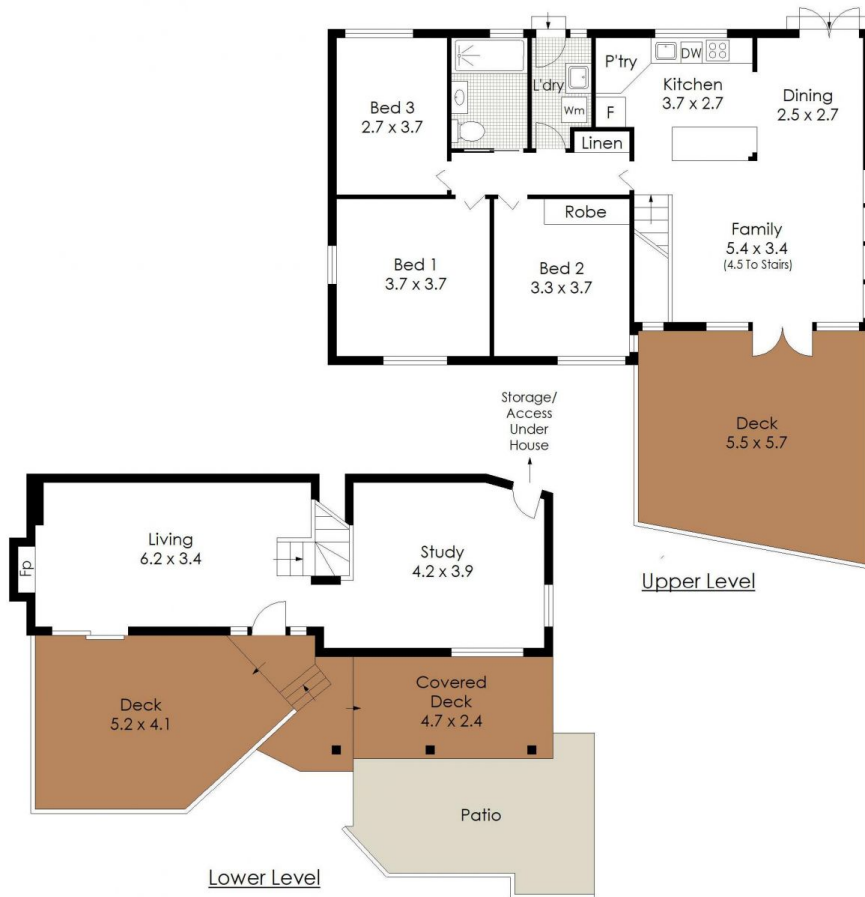

Site Plan (Scale Approximate)



Disclaimer: Sydney Floor Plans A.B.N. 80 952 665 571 mob. 0402073101  
 This plan serves only as a guide for marketing purposes. 05/06  
 Dimensions are approximate and should not be relied upon for specific detail.

41 Hillside Road, Newport

\*Internal Area Approx: 132 sqm

